

# Tech Bulletin: Assembling the Pole Mounting Clamps



HC 67 Box 592 \* Renick, WV 24966

[www.altalabinstrument.com](http://www.altalabinstrument.com)

(304) 497-2756

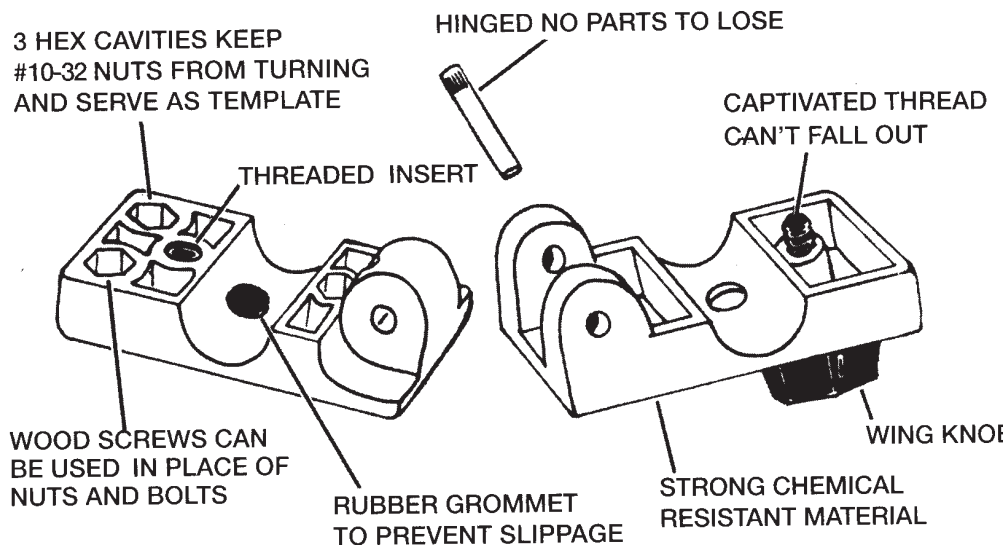

1. Put the 2 halves of clamp together aligning hinge holes. Then press hinge pin through.
2. Place the rubber grommet in the hole in the top of the clamp and push the barbed head until it pops through the hole. You can use soap to lubricate the grommet.
3. Screw DO NOT PUSH knob into clearance hole in the bottom of the clamp until knob floats freely.

## TECH BULLETIN:



# Eprom Upgrade in the Field

These instructions are for customers who have received a new eprom for upgrading their AltaCom for the new PRO Anemometer.

1) Determine the current version of your AltaCom by turning on the console and reading the version on the LCD during power up. If the version is greater than 2.26 proceed to Step 2.

**\*\*IMPORTANT\*\*** If the version is LESS THAN 2.26 (2.00, 2.01 etc.) STOP and call Altalab for more detailed instructions.

2) Turn the weatherstation OFF. Remove the 2 phillips head screws from the underside of the console, turn the console right-side up and remove the cover.

3) Locate the eprom with a version sticker on it. Notice that it has a small notch in one end nearest the front of the AltaCom case. You may need to remove the radio (silver box inside the console) to access this eprom.

4) Remove the radio if necessary. To remove the radio detach the 9pin ribbon cable and the antenna connection from the radio, also remove any screws holding the radio ground plane onto standoffs. The aluminum ground plane stays attached to the radio, and the entire assembly slips out of the case.

5) Use a small screwdriver or dental tool to remove the eprom. Insert the new eprom making sure to orient the notch in the correct direction. Check that all the legs are correctly in the socket. If you orient the eprom incorrectly it will not damage the weatherstation, the AltaCom will simply not work.

6) Before reconnecting the radio and putting the case back together check the swap by turning the weatherstation ON and making sure the new version number appears during power up.

**\*\*IF THE NEW EPROM DOESN'T WORK\*\*** call Altalab, you may need to make a simple jumper change.

Versions 2.57 adds support for WSI-PRO-23 Anemometer

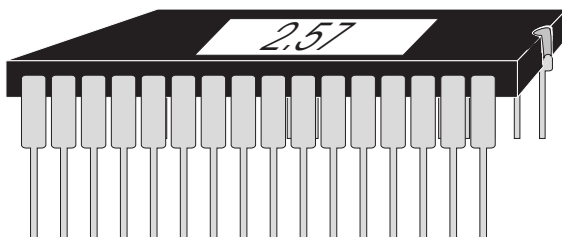

eprom, note notched end